



MPV VALVE

Specifications & Description



Product Numbers

Part#	Diameter	Hanbell Compressor	Opening PSI	Max. PSI	Working Temp.	PSI Drop
RC-MPV-1 1/2"	1 1/2"	RC2-100 - RC2-140, RC2-180 - RC2-200	3.6 ±0.3Bar 52 psi ± 4	28Bar 406 psi	<120°C 248F	<0.Bar 0 psi
RC-MPV-1 1/2"-TLD	1 1/2"	RC2-140B-TLD				
RC-MPV-2"	2"	RC2-230 - RC2-310, RC2-100F - RC2-200F				
RC-MPV-2 1/2"	2 1/2"	RC2-340 - RC2-470, RC2-230F - RC2-370F				
RC-MPV-3"	3"	RC2-510 - RC2-620, RC2-410F - RC2-580F				
RC-MPV-4"	4"	RC2-710 - RC2-930B, RC2-610F - RC2-930F				

Product Description

Minimum Pressure Valves are recommended in cold start conditions.

During a cold start up period, the system's condensing temperature is still low, the discharge pressure will stay at a low level which means the pressure differential between discharge and the suction side will not be enough for the compressor to run efficiently.

Under such working conditions, the compressor might have difficulties loading. Oil supply to bearings and internal cooling might not be enough, which can cause serious damage to those moving parts.

With the Minimum Pressure Valve, the pressure differential can be built up quickly after the start up so the capacity control and oil supply to those moving parts won't be an issue, allowing compressor protection to be achieved. In addition to the protection purpose, it also performs as a check valve to reduce the reverse running time after the compressors shutdown.

Flange on the minimum pressure valves are provided for the ease of installation. It can be installed on either the compressor's discharge port or external oil separator's discharge port (Flooded type compressor only).

DIAMETER	SIZE																			
	A	B	C	D	E	F	G	H	I	J	K	L	M	N	O	P	Q	R	S	T
1-1/2"	2.36	2.95	0.24	4.45	8.4	2.16	0.20	2.3	2.30	3.16	0.71	4.29	4.29	0.03	4.13	109	4.29	M16×2	4.13	0.91
2"	2.75	3.54	0.24	4.72	8.88	2.68	0.20	2.71	3.58	4.13	0.71	4.80	4.80	0.71	4.72	14.80	4.80	M16×2	4.72	0.98
2-1/2"	3.54	4.33	0.24	5.12	11	3.03	0.20	3.50	4.37	4.33	0.79	5.27	5.27	0.71	5.51	5.27	5.27	M16×2	5.51	0.98
3"	3.94	4.72	0.24	5.90	13.56	3.86	0.20	3.90	4.76	4.80	0.87	6.02	6.02	0.87	6.30	6.02	153	M20×2.5	6.30	1.06
4"	4.92	5.71	0.24	6.30	15.45	4.45	0.20	4.88	5.75	6.50	0.98	6.73	171	0.87	7.28	6.73	6.73	M20×2.5	7.23	1.18

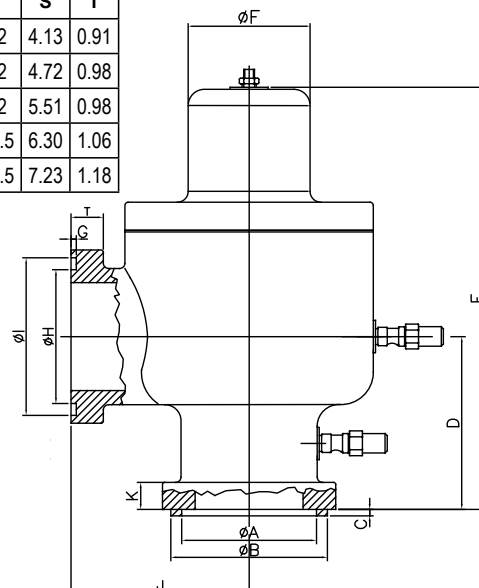
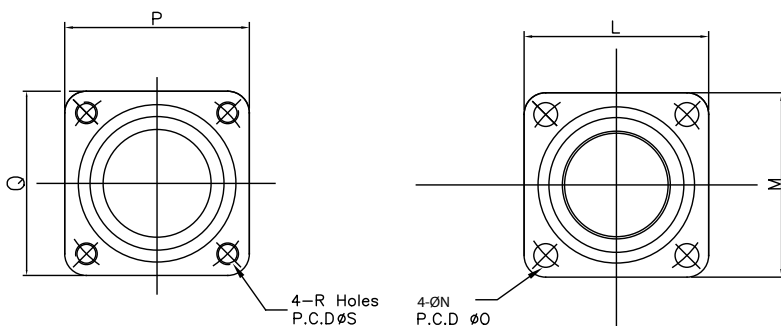

INSTALL APP



SCAN WITH PHONE
OR CLICK HERE